



中国·山东

真空设备



山东沃仕玛真空设备科技有限公司
Shandong WoShiMa vacuum equipment technology co., LTD

企业简介

山东沃仕玛真空设备科技有限公司是水环式真空泵、立式无油真空泵、摆线针轮减速机、罗茨真空泵及罗茨真空机组设备的专业制造商，同时我公司又开发了硅酮胶专用高粘度内齿轮泵。具有完善的质量体系，先进的检测手段，已通过ISO9001-2000质量体系认证。是一家集研发、生产、加工、安装、调试和完善的售后服务为一体的专业化真空设备制造商。我们的产品现广泛应用于有机硅、塑料机械、化工、矿山、砖瓦、铸造、陶瓷、泡塑、印染、冶金、镀膜、建材、造纸、玻璃、粮油、食品等行业。现已形成了专业化、规模化、集团化生产的模式，是您理想的合作伙伴。

商道酬诚是我们的宗旨；**质量为本**是我们的理念。我们在生产过程中精益求精，严格管理，层层设检，经客户应用证实：我们的产品性能卓越，质量可靠，服务周到。

我公司将与国内外新老客户携手共进，共创企业辉煌的明天！

Shandong Woshima Vacuum Equipment Technology Co., Ltd. is a professional manufacturer of water ring vacuum pump, vertical oil-free vacuum pump, cycloid reducer, roots vacuum pump and roots vacuum pump equipment, at the same time we also developed a special high viscosity silicone rubber internal gear pump. With a sound quality system, advanced detection means, our company has passed ISO9001-2000 quality system certification. We are a research and development, production, processing, installation, commissioning and perfect after-sales service as one of professional vacuum equipment manufacturers. Our products are widely used in organic silicon, plastic machinery, chemical industry, mining, brick and tile, casting, ceramics, foam plastic, printing and dyeing, metallurgy, coating, building materials, paper, glass, grain and oil, food and other industries. Our company has now formed a professional, large-scale, group production model, and is your ideal partner.

Equal pay, honesty is our tenet; quality is the soul is our philosophy. We strive for excellence in the production process, strict management, set up layers of inspection, confirmed by the customer application, our product performance, quality, reliable, courteous service.

Our company will work with new and old customers at home and abroad to work together to create brilliant tomorrow!



目 录

NYP 型内环式高粘度泵使用说明·····	01
NYP type inner ring type high viscosity pump instructions	
XD 系列旋片式真空泵·····	03
XD series rotary vane vacuum pump	
ZJ/ZJP 系列罗茨真空泵·····	04
ZJ/ZJP roots vacuum pump series	
单罗茨液环真空机组·····	05
Single roots liquid ring vacuum vacuum unit	
WLW-B 型系列消音立式无油真空泵·····	06
WLW-B series vertical type silencing oil-free vacuum pump	
WLW-B 型系列消音过滤立式无油真空泵·····	07
WLW-B series Sound attenuation filter vertical oil-free vacuum pump	
WLZJ 罗茨无油立式双级真空机组·····	08
WLZJ series Roots Vertical vertical double vacuum unit	
SZ 型水环式真空泵·····	09
SZ-type water ring vacuum pumps	
2BV 系列水环真空泵·····	10
2BV series water ring vacuum pumps	
2BV 真空泵改型产品·····	13
2BV vacuum pump modified products	
SK、2SK 系列水环真空泵·····	14
SK、2SK series water ring vacuum pumps	
2BE1 系列水环真空泵·····	15
2BE1 series water ring vacuum pumps	





NYP 型内环式高粘度泵使用说明

NYP type inner ring type high viscosity pump instructions

一、概述 Summary

NYP 系列内齿泵是根据石油、化工、涂料、油脂、医药、染料、食品等行业的需求，研制开发的新型容积式泵，由于该产品可选用不同材质和其独特的结构，因而广泛应用于不同性质，不同粘度的介质输送。

适用介质温度：-10℃ ~ 200℃

适用介质粘度：1.0cSt ~ 300.00cSt

Nyp series gear is a new positive displacement pump developed according to the needs of petroleum, chemical, coating, oil, medicine, dye, food, because the product can choose different materials and its unique structure, and is widely used in different properties, different viscosity medium transport.

Applicable medium temperature: -10 °C ~ 200 °C

Applicable medium viscosity: 1.0 CST ~ 300.00 CST



二、结构型式 Structural style

(1) 工作原理

具有内齿的驱动齿轮(外转子)带动内转子在全封闭的泵体内作同方向转动，泵体和前盖的月牙板使吸入口和排出口隔开；转动时在吸入口形成负压，液体被吸入，转子将液体带到排出口，受压排出泵体，完成了液体的输送。

(2) 结构

泵主要由内外转子、轴、泵体、前盖、托架、密封、轴承等组成。密封有机械密封和填料密封两种形式，对于高温、高粘稠度及腐蚀性较强的介质，选用填料密封。

输送易结晶物料时，在前盖和泵体上可设计带有保温夹套，工作时通蒸汽保温融化。泵可配安全阀，当泵或管路系统超压时，安全阀打开，形成内部回流，保证系统安全。

泵装置由泵、电机和底座组成。传动方式有桥式和直联式两种。从电机端向泵看，为顺时针旋转。

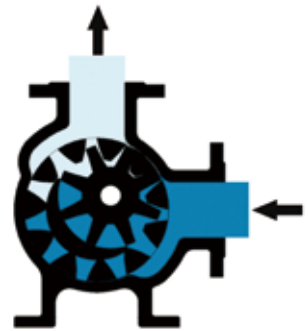

(1) working theory

The drive gear with internal tooth (outer rotor) drive the inner rotor in the closed pump body in the same direction, the pump body and the front cover make the suction inlet and discharge exit separated; When rotating, negative pressure is formed at the suction inlet, liquid is sucked in, the rotor will take the liquid to the exhaust outlet, press the pump body under pressure to complete the liquid transportation.

(2) structure

The pump mainly consists of inside and outside rotor, shaft, pump body, front cover, bracket, seal, bearing, etc. Sealing has two forms of mechanical seal and packing seal, for high temperature, high corrosion rate and corrosive medium, choose the packing seal.

When conveying fusible materials, the front cover and the bengtishang can be designed with the insulation jacket, and work when the steam insulation melts. When the pump can be equipped with safety valve, when the pump or pipeline system overpressure, safety valve is opened to form internal reflux to ensure system safety.

The pump device consists of a pump, a motor and a base. The transmission mode has two kinds of bridge and direct-connected. From the motor duanxiangben, for clockwise rotation.

三、优点 Advantages

- (1) 输送液体平稳、无脉动、振动小、噪音低。
- (2) 有很强的自吸性能。
- (3) 正确选用零件材料，可输送多种有腐蚀性的介质，使用温度可达 200℃。
- (4) 内外转子转向相同，磨损小，使用寿命长。
- (5) 泵的转速与流量呈线性函数关系，可适当改变转速来改变泵的流量。
- (6) 特别适用高粘稠度介质的输送。

(1) the liquid is stable, no pulsation, small vibration, low noise.

(2) has strong self-priming performance.

(3) the parts material is selected correctly, which can transport a variety of corrosive medium, and use temperature can reach 200 °C .

(4) the inner and outer rotors turn the same, wear small and long service life.

(5) the speed of the pump is linear with the flow rate, and the speed can be changed to change the flow of the pump.

(6) the transport of high consistency medium is especially suitable.



四、型号意义 Model Explanations

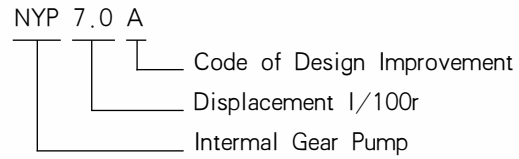
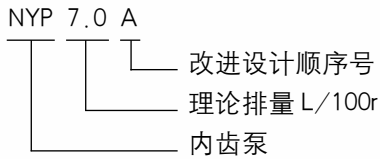

技术参数 Technical parameters

型号 Type	流量 Q Traffic		规定压力 Provisions of pressure Mpa	吸入及排出管口径 Suction and discharge pipe caliber	必须汽蚀余量 Must be covered by cavitation m	效率 The efficiency of %	减速方式 Slow way		
	m ³ /h	L/min					功率 power KW	转速 speed r/min	减速机 reducer
NYP3/1.0A	2	33.3	1.0	M48 × 2	5	45	3	587	YCJ71
NYP10/1.0A	6	100	1.3	M60 × 2		45	7.5	228	YCJ112
	8	133.3		M60 × 2		45	7.5	303	YCJ100
	10	166.7		M60 × 2		51	7.5	357	YCJ100
	12	200		M60 × 2		54	7.5	475	YCJ100
NYP30/1.0A	18	300	1.0	φ 80		54	15	305	YCJ112
	22	366.7		φ 80		58	15	359	YCJ112
	28	466.7		φ 80		65	15	479	YCJ112
NYP3/1.0A	1.5	25	1.0	M48 × 2		43	3	480	皮带轮传动 pulley drive
	2	33.3		M48 × 2		43	3	640	
NYP10/1.0A	8	133.3		M60 × 2		43	7.5	303	
	10	166.7		M60 × 2		49	7.5	357	
	12	200		M60 × 2		51	7.5	475	
NYP3/1.0A	3	50		M48 × 2		55	3	960	

密封方式为填料密封 The packing is sealed by packing

型号 Type	流量 Q Traffic		压力 pressure Mpa	吸入及排出管口径 Suction and discharge pipe caliber	必须汽蚀余量 Must be covered by cavitation m	效率 The efficiency of %	减速方式 Slow way			
	m ³ /h	L/min					功率 power KW	转速 speed r/min	减速机 reducer	
NYP3/1.0	2	33.3	1.0	G1 ¹ / ₂ "	5	45	3	587	YCJ71	
NYP10/1.0	6	100	1.3	G2 "		45	7.5	228	YCJ112	
	8	133.3		G2 "		45	7.5	303	YCJ100	
	10	166.7		G2 "		51	7.5	357	YCJ100	
	12	200		G2 "		54	7.5	475	YCJ100	
NYP30/1.0	18	300	1.0	φ 80		54	15	305	YCJ112	
	22	366.7		φ 80		58	15	359	YCJ112	
	28	466.7		φ 80		65	15	479	YCJ112	
NYP50/1.0	50	833.3	1.0	φ 150		52	37	128	YCJ315	
	80	1333.3		φ 150		58	45	208	YCJ355	
	100	1666.6		φ 150		65	55	253	YCJ355	
NYP3/1.0	1.5	25		1.0		G1 ¹ / ₂ "	43	3	480	皮带轮传动 pulley drive
	2	33.3				G1 ¹ / ₂ "	43	3	640	
NYP10/1.0	8	133.3				G2 "	43	7.5	303	
	10	166.7				G2 "	49	7.5	357	
	12	200				G2 "	51	7.5	475	
NYP3/1.0	3	50			G1 ¹ / ₂ "	55	3	960	Y132 S-6 与电机直联 And motor straight league	

密封方式为机械密封 Secret type of mechanical seal



XD 系列旋片式真空泵

XD series rotary vane vacuum pump

概述 Summary

XD 系列真空泵是一款基本型的真空获得设备，为单级压缩腔，三片旋片结构，采用专用真空泵油作为工作液。主要用于低中真空范围，用于抽除普通空气或惰性气体，也可抽除少量可凝性气体，如水蒸汽等。泵的工作压力为泵的极限压力到大气压范围内。产品因其坚固，耐用，可靠，经济的优点已经在各工作领域得到了越来越多的应用。

XD series vacuum pump is a basic type of vacuum obtain equipment, for single stage compression cavity, three pieces of rotary vane structure, using special vacuum pump is not as working fluid. Mainly used for low vacuum range, used for pumping ordinary air or inert gas, also can be to remove minor condensable gases such as water vapor, etc.. The pump working pressure for the pressure pump to the high pressure range. Products for its rugged, durable, reliable, economic advantages have been applied more and more in every field of work.

特点 Characteristic

- 结构紧凑轻巧，尤其适合机器设备配套
- 全系列风冷，无需冷却水（标准型）
- 低噪音，低震动，运行平稳，可靠，耐久
- 环保节能，排气洁净无油烟
- 操作维护简易且运行费用低廉
- 优质原材料及先进制造工艺生产，可连续不间断运行
- 中小规模泵采用电机直联驱动，进排气口采用国标螺纹
- 大流量型号采用皮带传动，进排气口采用国标法兰
- 中大规格型号可以选配加大散热器或水冷装置



The structure is compact and light, especially suitable for machine equipment
The whole series of air cooling, no need of cooling water (standard type)
Low noise, low vibration, smooth operation, reliable, durable
Environmental protection and energy saving, clean without oil fume exhaust
Operation and maintenance is simple and low cost of operation
The production of high quality raw materials and advanced manufacturing technology, continuous operation
Small and medium-sized pump using motor direct drive, the inlet and outlet using the national standard thread
Large flow model adopts belt transmission, the inlet and outlet flange with GB
Large specification models can be selected to increase the radiator or water cooling device

广泛应用于 Widely used in

包装、食品、印刷、纸业、木业、玻璃、砖陶、新型材料、橡胶塑料、环保、冶金、机械、电气、汽车、航天航空、饮料、制药、医院、电子、印刷线路板、半导体、光电及新能源等行业。

Packing, food, printing, paper, wood, glass, pottery, brick model material, rubber plastic, environmental protection, metallurgy, mechanical, electrical, automotive, aerospace, beverage, pharmaceutical, hospitals, electronic, printed circuit board, semiconductor, optoelectronics and new energy industry.



ZJ/ZJP 系列罗茨真空泵

ZJ/ZJP roots vacuum pump series

概述 Summary

ZJ 系列罗茨真空泵，一种无内压缩的旋转变容式真空泵，又称机械增压泵，其优点是在较低的入口压力时具有较高的抽气速率，它是目前获得中、高真空的主要抽气设备之一，其工作原理与罗茨鼓风机相似，主要由一对同步高速旋转的“8”字形转子与两个半圆形的泵腔组成。ZJ 系列罗茨真空泵不能单独排气，必须与前级泵（如滑阀泵、旋片式真空泵、水环式真空泵、油环泵等）串联使用，待被抽系统中的压力被前级真空泵抽到罗茨真空泵所能接受的压力时才能开始工作，否则将会因过载和过热而损坏。在前级泵进气口前面串联上 ZJ 系列罗茨真空泵组成机组可提高前级泵的真空度，在有效范围内大大提高抽气速率。ZJ 系列罗茨真空泵的极限压力由前级泵决定，技术参数表中数据为标准配置（配用双级油封式机械真空泵）时的低极限压力。



ZJ 系列罗茨真空泵在很宽的压强范围 ($1 \sim 1 \times 10^4 \text{pa}$) 有较大的抽速，对被抽除气体中含有灰尘和水蒸气不敏感，所以广泛使用于真空浇铸、真空熔炼、真空脱气、真空镀膜行业及化工医药行业的真空蒸馏、真空干燥等。

ZJ series Roots vacuum pump, vacuum pump containing a variable rotation without internal compression, also known as mechanical booster pump, the utility model has the advantages of low pressure at the entrance of pumping rate is higher, it is currently available in the main, high vacuum pumping equipment, the principle and the work of similar roots blower mainly by the pump cavity, a pair of synchronous high-speed rotation of the "8" shaped rotor and 2.5 circular form. ZJ roots vacuum pump series alone cannot exhaust, and must be before the pump (such as pump, rotary vane vacuum pump, water ring vacuum pump, oil ring pump) to be used in tandem pumping system pressure is pre vacuum pump to the roots vacuum pump can accept pressure to start work otherwise, will be due to overload and overheat and damage. The ZJ series Roots vacuum pump in front of the front air inlet of the pump can be used to improve the vacuum degree of the front stage pump, which can greatly improve the extraction rate. The limit pressure of ZJ series Roots vacuum pump is decided by the first stage pump, and the data in the technical parameter table is the lower limit pressure when it is used in the standard configuration.

The pressure range of ZJ series Roots vacuum pump in a wide ($1 \sim 1 * 10^4 \text{pa}$) with a large pumping speed, on the extraction of gas containing dust and water vapor is not sensitive, so widely used in vacuum casting, vacuum melting, vacuum degassing, vacuum coating and chemical industry pharmaceutical industry, vacuum distillation, vacuum drying etc.

ZJ/ZJP 系列罗茨真空泵主要技术参数

The main technical parameters of ZJ/ZJP series Roots vacuum pump

型号 Model	极限压力 Extreme Pressure Pa	抽气速率 The pumping rate L/S	最大允许压差 Maximum allowable pressure Pa	吸气口径 The inlet diameter mm	排气口径 The exhaust aperture mm	电机功率 Motor power KW	配用前级泵 With the former pump
ZJP-70	5×10^{-2}	70	6×10^3	80	50	1.1/1.5	2X-15
ZJP-150	5×10^{-2}	150	6×10^3	100	80	2.2/3	2X-30
ZJP-300	5×10^{-2}	300	5×10^3	150	100	4	2X-70
ZJP-600	5×10^{-2}	600	4×10^3	200	150	5.5/7.5	2X-30、ZJ-150
ZJP-1200	5×10^{-2}	1200	3×10^3	250	200	11/15	2X-70、ZJ-300
ZJP-2500	5×10^{-2}	2500	3×10^3	300	250	22/30	X-150、ZJ-600
2ZJ/2ZJP-70	3×10^{-2}	70	1.1×10^4	80	40	1.5	2X-8
2ZJ/2ZJP-150	3×10^{-2}	150	1.1×10^4	100	50	3	2X-15
2ZJ/2ZJP-300	3×10^{-2}	300	1×10^4	150	80	5.5	2X-30
2ZJ/2ZJP-600	3×10^{-2}	600	9×10^3	200	100	7.5/11	2X-70
2ZJ/2ZJP-1200	3×10^{-2}	1200	7×10^3	300	150	15	2X-30、ZJ-300



单罗茨液环真空机组

Single roots liquid ring vacuum vacuum unit

单罗茨液环真空机组主要性能参数表 Main performance parameter table of single roots liquid ring vacuum unit

机组型号 Machine group type	泵型号 Pump type		极限压力 Extreme pressure 水环 Water ring	抽气速率 The pumping rate L/s	进气口径 The inlet diameter mm	排气口径 The exhaust aperture mm	电机功率 Motor power kw	
	主泵 The main pump	前级泵 Before the pump						
JZJ(P)2S(Y)70-2	ZJ(P)70	2S(y)k2	300	70	80	50	1.5	5.5
JZJ(P)ZGZB70-1	ZJ(P)70	ZGZB-4500	300	70	80	50	1.5	7.5
JZJ(P)ZGZB150-3	ZJ(P)150	ZGZB-4500	300	150	100	50	3	7.5
JZJ(P)ZGZB150-1	ZJ(P)150	ZGZB-6500	300	150	100	50	3	11
JZJ(P)ZGZB300-3	ZJ(P)300	ZGZB-6500	300	300	150	50	4	11
JZJ(P)ZGZB300-1	ZJ(P)300	ZGZB-12000	300	300	150	80	4	22
JZJ(P)ZGZB600-3	ZJ(P)600	ZGZB-12000	300	600	200	80	7.5	22
JZJ(P)2S(Y)600-1	ZJ(P)600	2S(y)k25	300	600	200	100	7.5	55
JZJ(P)2S(Y)1200-3	ZJ(P)1200	2S(y)k25	300	1200	200	100	11	55



ZJP300/ZGZB6500 型罗茨液环机组
ZJP300/ZGZB6500 type roots liquid ring unit



ZJP600/2BE1-202 型罗茨液环机组
ZJP600/2BE1-202 type roots liquid ring unit

三罗茨液环真空机组主要性能参数表 The three roots of liquid ring vacuum unit main performance parameter table

机组型号 Machine group type	泵型号 Pump type				极限压力 Extreme pressure 水环 Water ring	抽气速率 The pumping rate L/s	进气口径 The inlet diameter mm	排气口径 The exhaust aperture mm	电机功率 Motor power kw			
	主泵 The main pump	中间泵 Intermediate pump	中间泵 Intermediate pump	前级泵 Before the pump								
JZJ(P)2S(Y)300-222	ZJ(P)300	ZJ(P)150	ZJ(P)70	2S(Y)K2	1	300	150	50	4	3	1.5	5.5
JZJ(P)ZGZB300-221	ZJ(P)300	ZJ(P)150	ZJ(P)70	ZGZB-4500	1	300	150	50	4	3	1.5	7.5
JZJ(P)ZGZB300-221T	ZJ(P)300	ZJ(P)150	ZJ(P)70	ZGZB-6500	1	300	150	50	4	3	1.5	11
JZJ(P)ZGZB600-223	ZJ(P)600	ZJ(P)300	ZJ(P)150	ZGZB-4500	1	600	200	50	7.5	4	3	7.5
JZJ(P)ZGZB600-221	ZJ(P)600	ZJ(P)300	ZJ(P)150	ZGZB-6500	1	600	200	50	7.5	4	3	11
JZJ(P)ZGZB1200-421	ZJ(P)1200	ZJ(P)300	ZJ(P)150	ZGZB-6500	1	1200	250	50	7.5	4	3	11
JZJ(P)ZGZB1200-223	ZJ(P)1200	ZJ(P)600	ZJ(P)300	ZGZB-6500	1	1200	250	50	11	7.5	4	11
JZJ(P)ZGZB1200-221	ZJ(P)1200	ZJ(P)600	ZJ(P)300	ZGZB-1200	1	1200	250	80	11	7.5	4	22



WLW-B 型 系列消音立式无油真空泵

WLW-B series vertical type silencing oil-free vacuum pump

用途 Use

WLW-B 型消音立式无油真空泵，我公司与科研院校合作开发并经十余年不断改进的成熟产品，它广泛应用于有机硅、石油、食品、制药、化工等行业的真空输送提料、提炼、蒸馏、浓缩、干燥、真空包装、气体解析、尾气回收等场合，是取代 W 型卧式往复泵的最佳替代产品。

WLW-B type silencer vertical oil-free vacuum pump, mature product cooperative development of our company and research institutions, and after more than ten years of continuous improvement, it is widely used in the vacuum oil, silicone, food, pharmaceutical, chemical and other industries of the conveyor feeding, refining, distillation, concentration, drying, vacuum packaging, gas analysis, tail gas recovery and so on, is the best alternative products to replace the W type horizontal reciprocating pump.



特点 Characteristic

- | | |
|-----------------------|---|
| 1、气缸与活塞无油润滑。 | 1, the cylinder and the piston without oil lubrication. |
| 2、节能 (33%) 节水 (50%) 。 | 2, energy saving and water saving (33%) (50%) . |
| 3、占地面积小。 | 3, small footprint. |
| 4、噪声低。 | 4, low noise. |
| 5、外观简洁，操作维修方便。 | 5, the appearance of simplicity, convenient operation and repair. |

WLW-B 型无油立式真空泵主要技术参数

WLW-B type without major technical parameters of vertical vacuum pump oil

参数 Parameters 项目 Project	型号 Model	抽气速度 Pumping speed L/S(m ³ /h)	极限压力 Extreme pressure mmHg (X10 ³ Pa)	电机 Electric machinery		吸气口径 The suction path (mm)	排气口径 The exhaust path (mm)	噪声 Noise dB (A)	整机重量 The weight of the whole machine (kg)
				型号 Model	功率 Power kw				
	WLW-30B	30(108)	15(2.0)	Y132S-6	3	Φ50	Φ50	≤ 70	350
	WLW-50B	50(180)	15(2.0)	Y132M ₁ -6	4	Φ50	Φ50	≤ 70	500
	WLW-70B	70(250)	15(2.0)	Y132M ₂ -6	5.5	Φ50	Φ50	≤ 75	510
	WLW-100B	100(360)	15(2.0)	Y160M-6	7.5	Φ100	Φ100	≤ 78	750
	WLW-150B	150(540)	15(2.0)	Y160L-6	11	Φ125	Φ125	≤ 80	940
	WLW-200B	200(720)	15(2.0)	Y180L-6	15	Φ125	Φ125	≤ 80	1000
	WLW-300B	300(1080)	15(2.0)	Y200L-6	22	Φ160	Φ160	≤ 80	1500
	WLW-400B	400(1440)	15(2.0)	Y225M-6	30	Φ160	Φ160	≤ 80	1700
	WLW-600B	600(2160)	15(2.0)	Y280S-6	45	Φ250	Φ250	≤ 80	3100



WLW-B 型 系列消音过滤立式无油真空泵

WLW-B series Sound attenuation filter vertical oil-free vacuum pump

用途 Use

WLW-B 型消音过滤立式无油真空泵，是我公司与科研院校合作开发并经十余年不断改进的成熟产品，它广泛应用于有机硅、石油、食品、制药、化工等行业的真空输送提料、提炼、蒸馏、浓缩、干燥、真空包装、气体解析、尾气回收等场合，是取代 W 型卧式往复泵的最佳替代产品。

我公司根据化工行业的特点，在工作过程中容易产生粉尘及细微颗粒物吸入到真空泵腔体中，我公司特开发了消音过滤型立式无油真空泵，有效的阻止了粉尘吸入到腔体内，过滤效果好，延长真空泵使用寿命，大大减少了维修量。

WLW-B type silencer vertical oil-free vacuum pump, mature product cooperative development of our company and research institutions, and after more than ten years of continuous improvement, it is widely used in the vacuum oil, silicone, food, pharmaceutical, chemical and other industries of the conveyor feeding, refining, distillation, concentration, drying, vacuum packaging, gas analysis, tail gas recovery and so on, is the best alternative products to replace the W type horizontal reciprocating pump.

Our company according to the characteristics of the chemical industry, in the work process is easy to produce dust and fine particles into the cavity of vacuum pump, our company developed the silencer filter type oil-free vacuum pump, effectively prevent dust inhalation into the chamber, filtering effect is good, the service life of the air pump Yan Changzhen, greatly reduced the maintenance the amount of.



特点 Characteristic

- | | |
|----------------------|--|
| 1、气缸与活塞无油润滑。 | 1. the cylinder and the piston without oil lubrication. |
| 2、节能 (33%) 节水 (50%)。 | 2. energy saving and water saving (33%) (50%). |
| 3、占地面积小。 | 3. small footprint. |
| 4、噪声低。 | 4. low noise. |
| 5、外观简洁，操作维修方便。 | 5. the appearance of simplicity, convenient operation and repair. |
| 6、延长真空泵寿命，减少维修量。 | 6. To extend the service life of vacuum pump, reducing the amount of repair. |

WLW-B 型无油立式真空泵主要技术参数

WLW-B type without major technical parameters of vertical vacuum pump oil

参数 Parameters 项目 Project	型号 Model	抽气速度 Pumping speed L/S(m ³ /h)	极限压力 Extreme pressure mmHg (X10 ³ Pa)	电机 Electric machinery		吸气口径 The suction path (mm)	排气口径 The exhaust path (mm)	噪声 Noise dB (A)	整机重量 The weight of the whole machine (kg)
				型号 Model	功率 Power kw				
	WLW-30B	30(108)	15(2.0)	Y132S-6	3	Φ50	Φ50	≤ 70	350
	WLW-50B	50(180)	15(2.0)	Y132M ₁ -6	4	Φ50	Φ50	≤ 70	500
	WLW-70B	70(250)	15(2.0)	Y132M ₂ -6	5.5	Φ50	Φ50	≤ 75	510
	WLW-100B	100(360)	15(2.0)	Y160M-6	7.5	Φ100	Φ100	≤ 78	750
	WLW-150B	150(540)	15(2.0)	Y160L-6	11	Φ125	Φ125	≤ 80	940
	WLW-200B	200(720)	15(2.0)	Y180L-6	15	Φ125	Φ125	≤ 80	1000
	WLW-300B	300(1080)	15(2.0)	Y200L-6	22	Φ160	Φ160	≤ 80	1500
	WLW-400B	400(1440)	15(2.0)	Y225M-6	30	Φ160	Φ160	≤ 80	1700
	WLW-600B	600(2160)	15(2.0)	Y280S-6	45	Φ250	Φ250	≤ 80	3100



WLZJ 罗茨无油立式双级真空机组

WLZJ series Roots Vertical vertical double vacuum unit

用途 Use

WLZJ 罗茨无油立式双级真空机组为我厂自行开发的新一代真空机组，是以罗茨泵为主泵，WLW 型无油立式往复泵作为前级泵串联而成的真空机组。广泛应用于电子、真空镀膜、化纤、冶金、热处理、焊接，化工等行业的真空蒸馏、结晶、干燥等过程。

WLZJ series Roots Vertical vertical double vacuum unit for a new generation of vacuum unit developed by our company independently, roots pump is the main pump, vacuum unit of WLW type oil free vertical reciprocating pump which as the pre pump series. Widely used in electronics, vacuum coating, chemical fiber, metallurgy, heat treatment, welding, vacuum distillation, crystallization, drying and other processes of chemical industry.

特点 Characteristic

与其他机组相比，具有以下优点：

- 1、极限真空度高，真空度长期稳定；
- 2、较高真空状态下抽气速率大；
- 3、效率高，能耗低；
- 4、过流部分无油润滑，有利于尾气的回收；
- 5、无二次水污染，更加环保。

Compared with other units, has the following advantages:

- 1, the limit of high vacuum degree, vacuum degree of long-term stability;
- 2, higher vacuum pumping rate;
- 3, high efficiency, low energy consumption;
- 4, the over-current part without oil lubrication, beneficial to the recovery of tail gas;
- 5, no two times more water pollution, environmental protection.



一、罗茨 + 无油真空泵机组 Roots + oil-free vacuum

项目 Project	主罗茨真空泵 The main roots vacuum pump					前级无油真空泵 The front stage oil free vacuum pump					重量 Weight kg	外形尺寸 The shape size L × W × H
	型号 Model	抽速 L/S Pumping speed	绝压 Pa Absolute pressure	功率 kw Power	电机转速 Motor speed r/min	型号 Model	抽速 L/S Pumping speed	绝压 Pa Absolute pressure	功率 kw Power	电机转速 Motor speed r/min		
WLZJ-50-70	ZJ-70	70	133	1.5	2900	WLW-50	50	2000	4	960	720	1.3 × 1 × 1.4
WLZJ-70-150	ZJ-150	150	133	3	2900	WLW-70	70	2000	5.5	960	838	1.45 × 1.1 × 1.4
WLZJ-100-150	ZJ-150	150	133	3	2900	WLW-100	100	2000	7.5	960	1100	1.6 × 1.1 × 1.6
WLZJ-150-300	ZJ-300	300	133	4	1450	WLW-150	150	2000	11	960	1620	1.9 × 1.35 × 1.75
WLZJ-200-600	ZJ-600	600	133	5.5	2900	WLW-200	200	2000	15	960	1710	1.9 × 1.4 × 1.75
WLZJ-300-600	ZJ-600	600	133	5.5	2900	WLW-300	300	2000	22	960	2260	2.1 × 1.4 × 1.75

二、罗茨 + 无油真空泵机组 Roots + oil-free vacuum

项目 Project	主罗茨真空泵 2					中间罗茨真空泵 1					前级无油真空泵					重量 Weight kg	外形尺寸 The shape size L × W × H
	型号 Model	抽速 L/S Pumping speed	绝压 Pa Absolute pressure	功率 kw Power	电机转速 Motor speed r/min	型号 Model	抽速 L/S Pumping speed	绝压 Pa Absolute pressure	功率 kw Power	电机转速 Motor speed r/min	型号 Model	抽速 L/S Pumping speed	绝压 Pa Absolute pressure	功率 kw Power	电机转速 Motor speed r/min		
WL2ZJ-70-70-150	ZJ-150	150	20	3	2900	ZJ-70	70	133	1.5	2900	WLW-70	70	2000	5.5	960	948	1.4 × 1.1 × 1.6
WL2ZJ-100-150-150	ZJ-150	150	20	3	2900	ZJ-150	150	133	3	1450	WLW-100	100	2000	7.5	960	1358	1.6 × 1.3 × 1.8
WL2ZJ-100-150-300	ZJ-300	300	20	4	1450	ZJ-150	150	133	3	2900	WLW-100	100	2000	7.5	960	1648	1.75 × 1.3 × 1.8
WL2ZJ-150-300-600	ZJ-600	600	20	5.5	2900	ZJ-300	300	133	4	1450	WLW-150	150	2000	11	960	2120	1.9 × 1.4 × 1.9
WL2ZJ-200-600-1200	ZJ-1200	1200	20	11	1450	ZJ-600	600	133	5.5	2900	WLW-200	200	2000	15	960	3320	1.9 × 1.4 × 1.9



SZ 型水环式真空泵

SZ-type water ring vacuum pumps

水环真空泵工作原理

Working principle of water ring vacuum pumps

叶轮相对泵壳偏心安装，叶轮旋转时产生与叶轮偏心的水环，充满在叶片中间的水，不断地作周期性的往复运动，改变叶片中间的容积，在固定的吸气口和排气口的相应配合下，完成吸气、压缩和排气过程，从而形成真空。

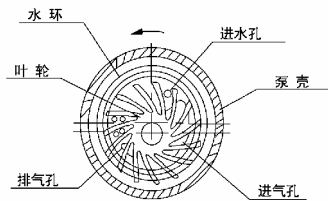

The impeller is fixed eccentrically inside the pump. When the impeller rotates, a liquid that is eccentric with the impeller is formed. The water, full of the blades, continues to do periodic reciprocating motion to alternate the capacity in the middle of them. With the corresponding of stationary suction port and the exhaust port, it completes the process of suction, compression and exhaust, thereby forming the vacuum.

一、SZ 系列真空泵主要技术参数 Main Technical parameters Of SZ series water ring pumps

型号 Model	最大气量 Maximum volume m ³ /min	极限真空度 Limit vacuum degree hpa	输入功率 Input power Kw	转速 Rotation speed r/min	补充水用量 Supplementary water consumption m ³ /h	重量 Weight Kg
SZ-0.5	0.5	80	1.5	2840	0.23	28
SZ-1	1		2.2	2840	0.23	32
SZ-2	2		4.0	2890	0.45	80
SZ-3	3		5.5	1440	0.4	125

二、外形尺寸 Outline size

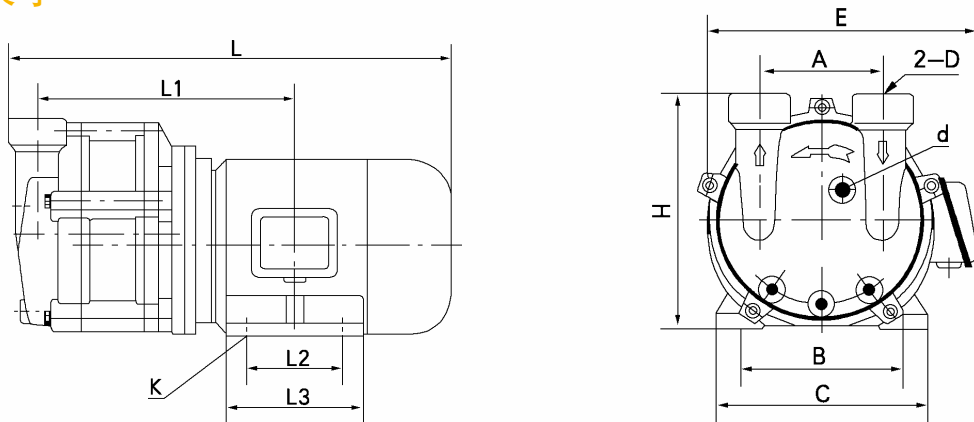

型号 Model	A	B	C	E	L	L ₁	L ₂	L ₃	D	d	H	K
SZ-0.5	80	140	180	255	445	250	100	130	G1"	Rc1/2"	194	10
SZ-1	100	140	180	255	490	280	125	160	G1"	Rc1/2"	194	10
SZ-2	110	190	245	285	563	327	140	180	G1"	Rc1/2"	237	12
SZ-3	160	216	280	360	630	360	140	200	G2"	Rc1/2"	320	12

注：本样本提供各系列产品外型尺寸、参数仅供选型参考，如有改动恕不另行通知。

Note: This sample provides the outline size of series products and the reference data is just for your selection of the type of products. If the data is changed, please pardon us that we can't instruct you in time.



2BV 系列水环真空泵

2BV series water ring vacuum pumps

概述 Sketch

2BV 系列水环真空泵适于抽除气体和水蒸气，吸气压力达到 33mbar 绝压 (97%真空度)，当真空泵在吸气压力低于 80mbar 的状态下长期工作时，应联接汽蚀保护管以对泵进行保护，如配大气喷射器（见附件表）吸气压力可达 10mbar，喷射器可直接安装在真空泵上。作为压缩机用时，其压力最大至 0.26MPa（绝压）。

水环真空泵及压缩机被广泛用于石油化工、制药、食品、制糖工业等领域，由于在工作过程中，气体的压缩过程是等温的，所以在压缩和抽吸易燃易爆气体时，不易发生危险，其应用更加广泛。



2BV series water ring vacuum pumps are used to aspirate gases and vapor. Its suction pressure can reach 33mbar (absolute pressure) (97% vacuum degree). When the vacuum pumps work for a long time under the suction pressure near to the ultimate vacuum (80mbar), it needs to connect with cavitations protection tube in order to eliminate screaming and protect the pump. For example, you can install an air ejector. In this way, the suction pressure can reach 10mbar. Moreover, the air ejection can be directly installed on the vacuum pump. As a compressor, the ultimate pressure is 0.26MPa (absolute pressure).

The water ring vacuum pumps and the compressors are widely used in petrochemical, pharmacy, food, sugar industry, etc. During the operation, the gas is compressed isothermally, therefore, there doesn't exist any danger in the process of compressing and aspirating the flammable and explosive gas. Thus it can be used more widely.

结构及特点 Structure and features

- 1、机泵同轴式直联设计，节省空间，易于安装；
- 2、采用机械密封作为标准配置，消除了泄露，维护简便；
- 3、运行平衡，噪音可低至 62 分贝；
- 4、统一的耐腐蚀设计，青铜叶轮提高了泵的腐蚀性，不锈钢材质则更适用于更为苛刻的应用；
- 5、独特的柔性排气口设计，不会产生过压缩，确保了 2BV 在其性能范围内效率最佳。

1. The direct-coupled design is easy to install and can save space.
2. The standard configuration adopts the John Crane mechanical seal which can eliminate leakage and easy to maintain.
3. Stable Operation and noise can be reduced to 62 decibel.
4. All 2BV series use the aluminum bronze impeller with strong corrosion resistance and durability. And the stainless steel can work in more hard conditions.
5. Special flexible exhaust port can avoid over-pressure and ensure the best efficiency within the range of its performance.

技术参数 Technical parameters

曲线编号 Curve number	产品型号 Product model	最大气量 Maximum volume m ³ /min	极限真空 Limit vacuum -Mpa	电机功率 Motor power kW	泵转速 Pump rotation speed r/min	工作液流量 Working fluid flow L/min	噪音 Noise db(A)	重量 Weight Kg
60V	2BV2060	0.45	0.097	0.81	2880	2	62	37
61V	2BV2061	0.86	0.097	1.45	2880	2	65	41
70V	2BV2070	1.33	0.097	2.35	2850	2.5	66	66
71V	2BV2071	1.83	0.097	3.85	2860	4.2	72	85
110V	2BV5110	2.75	0.097	4	1450	6.7	63	120
111V	2BV5111	3.83	0.097	5.5	1450	8.3	68	150
121V	2BV5121	4.66	0.097	7.5	1450	10	69	210
131V	2BV5131	6.66	0.097	11	1430	15	73	280
161V	2BV5161	8.33	0.097	15	970	20	74	390
110V	2BV6110	2.75	0.097	4	1450	6.7	63	
111V	2BV6111	3.83	0.097	5.5	1450	8.3	68	
121V	2BV6121	4.66	0.097	7.5	1450	10	69	
131V	2BV6131	6.66	0.097	11	1430	15	73	
161V	2BV6161	8.33	0.097	15	970	20	74	



性能曲线 Performance curve

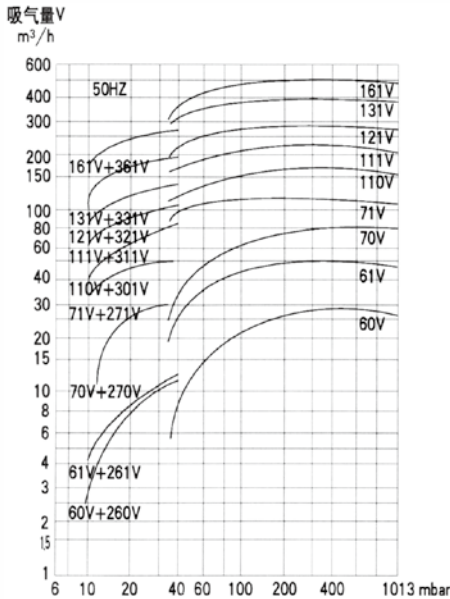

注：该性能曲线是在吸入介质为 20°C 的饱和空气，工作液温度为 15°C，排气压力 1013mbar 的状态下得到的。性能允许差 ±10%。

Note:
The data in table obtained about for Air temperature 20°, Water temperature 15°, Atmosphere 1013hpa following conditions. Input medium is saturation air. Function tolerance: ±10%.

选型示例 Selection of sample

①设计点参数：Design parameters

吸气量 $V = 100\text{m}^3/\text{h}$

Inspiratory capacity $V = 100\text{m}^3/\text{h}$

吸气压力 $P1 = 10\text{mbar}$

Suction pressure $P1 = 10\text{mbar}$

②其余参数同标准状态（见注）

The remaining parameters is the same as the standard state(Note)

选择与设计点①最接近的一条曲线

Choose the closest curve to design parameter ①

③本例中为 71V

In this example 71V

根据曲线编号查出相应的产品型号（即定货号，但仅限于标准型），如本例中可从 71V 查得泵型为 2BV2071。

Find out corresponding product model according to the curves (that is, order product number, but limited to the standard type), for example, you can trace pump model 2BV2071 from 71V.



2BV2 外形及安装尺寸 2BV2 Outline and Installation size

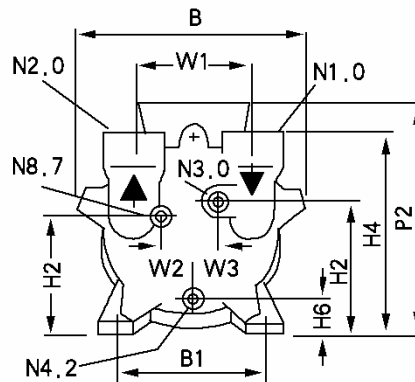
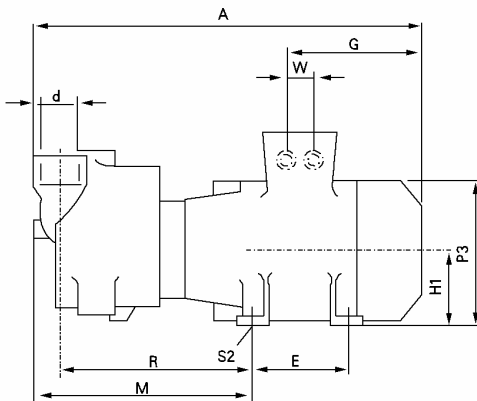

型号 Model	A	B	B1	E	H1	H2	H3	H4	H6	M	P2	P3
2BV2-060	450	186	140	100	90	118	126	195	37.5	244	250	180
2BV2-061	476	186	140	100	90	118	126	195	37.5	263	250	180
2BV2-070	545	233	160	140	100	128	146	222	33	280	270	203
2BV2-071	566	233	190	140	112	140	158	234	45	309	300	225

型号 Model	R	S2	W1	W2	W3	d	N3.0	N4.2	N8.7
2BV2-060	217	10	110	25.5	21	G1"	G" 3/8	G" 1/4	G" 3/8
2BV2-061	236	10	110	25.5	21	G1"	G" 3/8	G" 1/4	G" 3/8
2BV2-070	252	12	110	33	27	G1" 1/2	G" 3/8	G" 1/4	G" 3/8
2BV2-071	278	12	110	33	27	G1" 1/2	G" 3/8	G" 1/4	G" 3/8



2BV5 外形及安装尺寸 2BV5 Outline and Installation size

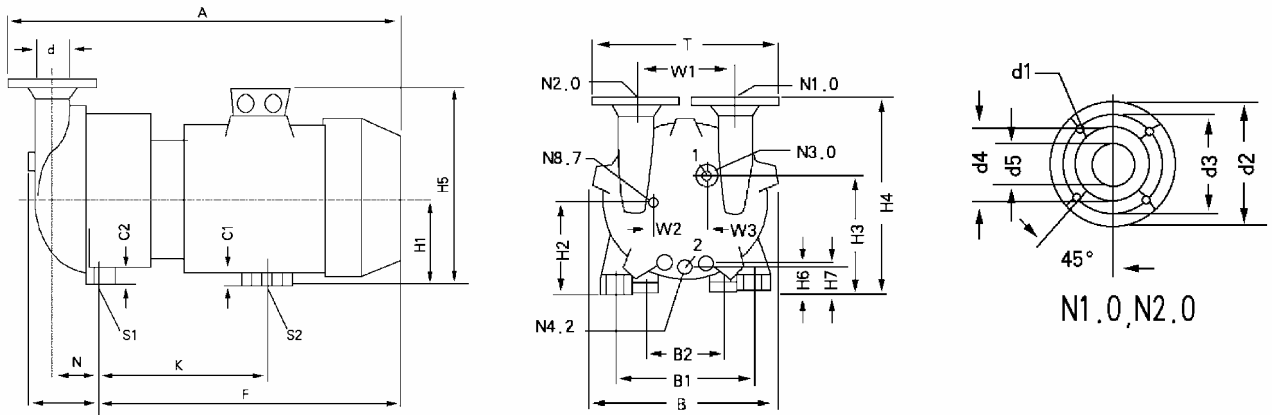

N1.0 吸气口 Suction port
 N2.0 排气口 Exhaust port
 N3.0 工作液接口 Working fluid interface
 N4.2 排水口 Drainage outlet
 N8.7 汽蚀保护 (内置) Cavitation protection (Inside)

型号 Model	A	B	B1	B2	C1	C2	H1	H2	H3	H4	H5	H6	H7	K	L
2BV5110	673	325	255	190	41	26	140	156	202	361	328	38	57	342	130
2BV5111	679	325	265	216	36	26	150	166	212	371	363	48	68	348	130
2BV5121	771	347	265	216	36	26	150	167	217	385	363	39	60	430	147
2BV5131	852	377	300	254	35	30	175	194	249	427	435	53	76	477.5	147
2BV5161	1044	479	370	279	30	30	210	225	303	521	485	51	80	565	201

型号 Model	F	N	S1	B2	T	d1	d2	d3	d4	d5
2BV5110	464	92	12 × 23	φ 12	340	19	160	123	97	52
2BV5111	500	92	12 × 23	φ 12	340	19	160	123	97	52
2BV5121	584	97	12 × 23	φ 12	381.5	19	182	142	113	66.5
2BV5131	658.5	103	15 × 23	φ 15	381.5	19	182	142	113	66.5
2BV5161	808	138	15 × 27	φ 15	450	22	200	156	130	80

型号 Model	w1	w2	w3	" d(N1.0, N2.0) "	N3.0	N4.2	N8.7
2BV5110	180	52	27	DN50	G 3/4"	G 3/8"	G 3/8"
2BV5111	180	52	27	DN50	G 3/4"	G 3/8"	G 3/8"
2BV5121	200	57	29	DN65	G 3/4"	G 3/8"	G 3/8"
2BV5131	200	57	29	DN65	G 3/4"	G 3/8"	G 3/8"
2BV5161	250	81	41	DN80	G 3/4"	G 3/8"	G 3/8"



2BV 真空泵改型产品

2BV vacuum pump modified products



ZGZB 型水环真空泵
ZGZB Water ring vacuum pump



ZGZB 型水环真空泵 (皮带)
Zgzb xing water ring vacuum pump (belt)

一、概述 Sketch

ZGZB 型水环真空泵是我公司针对 SZ、2BY、2SK 系列水环真空泵的特点研制开发的。该泵具有节能高效、结构合理、维修简单、使用寿命长、日常维护及维修成本低、稳定性好等优点，同时该真空泵采用机械密封，大大提高了密封性能。该泵将 2SK、2BY 水环真空泵的优点与一身，该泵具有维修方便、稳定性好，广泛应用于化工行业、陶瓷行业、印染行业、泡塑行业、铸造等行业，是其他水环真空泵无法比拟的，是对用户负责的产品。

ZGZB type water ring vacuum pump is based on the characteristics of SZ, 2BY, 2SK series water ring vacuum pump. The pump with high efficiency and energy saving, reasonable structure, simple maintenance, long service life, routine maintenance and repair is low cost, good stability and other advantages such as, at the same time the vacuum pump with mechanical seal, and greatly improves the sealing performance. The pump will 2SK, 2by water ring vacuum pump has the advantages of and a body, the pump has convenient maintenance, good stability, is widely used in the chemical industry, ceramic industry, printing and dyeing industry, plastic industry, casting industry, other water ring vacuum pump can not match the, is responsible for the user of the products

二、ZGZB 系列型真空泵主要技术参数 (直连) Two, ZGZB series vacuum pump main technical parameters (direct)

产品型号 Product model	抽气量 Pumping gas m ³ /min	极限压力 Extreme pressure MPa	输入功率 The input power kw	转速 Rotating speed r/min	工作液流量 Working fluid flow m ³ /h	建议替代产品型号 Suggest alternative The product model
ZGZB-2500	2.5	0.098	4	1440	0.4	2SK-1.5、2BY5-110
ZGZB-3500	3.5	0.098	5.5	1440	0.5	SK-3、2BY5-111
ZGZB-4500	4.5	0.098	7.5	1440	0.6	2SK-3、2BY5-121
ZGZB-6500	6.5	0.098	11	1440	0.9	2SK-6、2BY5-131
ZGZB-8500	8.5	0.098	15	1440	1.2	2SK-9、2BY5-161

二、ZGZB 系列型真空泵主要技术参数 (皮带) Two, ZGZB series vacuum pump main technical parameters (belt)

产品型号 Product model	抽气量 Pumping gas m ³ /min	极限压力 Extreme pressure MPa	输入功率 The input power kw	转速 Rotating speed r/min	工作液流量 Working fluid flow m ³ /h	建议替代产品型号 Suggest alternative The product model
ZGZB-8500	8.5	0.098	15-4	970	0.4	2BE152-0
ZGZB-10000	10	0.098	18.5-4	1100	0.5	2BE153-0
ZGZB-12000	12	0.098	22-4	1170	0.6	2BE153-0
ZGZB-20000	20	0.098	37-4	880	0.9	2BE252-0
ZGZB-30000	30	0.098	55-4	920	1.2	2BE253-0
ZGZB-40000	40	0.098	75-4	1000	1.5	2BE253-0
ZGZB-46000	46	0.098	90-4	980	1.8	2BE303-0
ZGZB-66000	66	0.098	132-4	800	2.5	2BE305-1
ZGZB-96000	96	0.098	185-4	760	3.0	2BE353-0



SK、2SK 系列水环真空泵

SK、2SK series water ring vacuum pumps

一、概述 Sketch

SK、2SK 系列两级水环真空泵是我厂根据行业标准 JB/T7255-94《水环式真空泵和水环压缩机》之规定发展的真空泵，具有真空度高，在高真空区间抽速大以及结构紧凑、使用可靠、装拆方便等特点。

SK, two 2SK series water ring vacuum pump is a vacuum pump factory in accordance with the provisions of the industry standard JB/T7255-94 "water ring vacuum pump and water ring compressor" development, has a high vacuum degree in high vacuum pumping speed and large range of compact structure, reliable use, convenient assembly and disassembly.



2SK 水环真空泵
2SK water ring vacuum pump

二、SK 系列真空泵主要技术参数 Main Technical parameters Of SK series water ring vacuum pumps

型号 Model	抽气量 Exhaust volume(m ³ /min)		极限压力 Extreme pressure (mmHg)	电机功率 Motor power(KW)		泵转速 Pump rotation speed (r.p.m)	压缩机压力 Compressor pressure (MPa)	吸排气口径 Suction and exhaust caliber(mm)	泵重 Pump weight (整机)(Kg)
	最大气量 Maximum volume	吸入压力 Suction pressure -0.04MPa 时		真空泵 Vacuum pump	压缩机 Compressor				
SK-1.5	1.5	1.35	-700	4	5.5	1440	1-0.1	70	200
SK-3	3	2.8	-700	5.5	7.5	1440	1-0.1	70	320
SK-6	6	5.4	-700	11	15	1440	1-0.1	80	460
SK-12	12	10.8	-700	18.5	30	970	1-0.1	80	750
SK-20	20	18	-700	37	55	730	1-0.1	150	1700
SK-30	30	27	-700	55	75	730	1-0.1	150	2300
SK-42	42	37.8	-700	75	-	730	-	150	2500

三、2SK 系列真空泵主要技术参数 Main Technical parameters Of 2SK series water ring vacuum pumps

型号 Model	抽气量 Exhaust volume(m ³ /min)		极限真空度 Limit Extreme pressure (MPa) (mmHg)	功率 Power (Kw)	转速 Rotation speed (r/min)	供水量 Water supply (L/min)	口径 Caliber		泵重 pump weight (含电机)(Kg)	建议替代 产品型号 Suggested alternative product model
	最大气量 Maximum volume	吸入压力为 -0.093MPa 时 (-700mmHg) Suction pressure					进 Inlet	出 Outlet		
2SK-1.5	1.5	0.9	-0.098 (-735)	4	1440	10-15	40	40	200	2BV5110
2SK-3	3	2	-0.098 (-735)	7.5	1440	15-20	40	40	260	2BV5111
2SK-6	6	4	-0.098 (-735)	15	1460	25-35	50	50	460	2BV5131
2SK-12	12	8	-0.098 (-735)	22	970	40-50	100	100	850	2BE1 202
2SK-20	20	14	-0.098 (-735)	45	740	60-80	125	125	1550	2BE1 252-660
2SK-30	30	20	-0.098 (-735)	55	741	60-80	125	125	1800	2BE1 253-660



2BE1 系列水环真空泵

2BE1 series water ring vacuum pumps



2BE1 水环式真空泵
2BE water ring vacuum pump



2BE1 不锈钢水环真空泵
2BE stainless steel water ring vacuum pump

一、概述 Summary

2BE1 系列水环真空泵，是我厂在多年科研成果和生产经验的基础上，结合国际同类产品先进技术，研制开发的高效节能产品。通常用于抽吸不含固体颗粒，不溶于水，无腐蚀性的气体，以便在密闭容器中形成真空和压力。通过改变结果材料，亦可用于抽吸腐蚀气体或以腐蚀性液体做工作液。广泛用于造纸、化工、石化、轻工、制药、食品、冶金、建材、石器、洗煤、选矿、化肥等行业。本系列泵采用单级单作用的结构形式，具有结构简单，维修方便，运行可靠，高效节能的优点，并能适应排水量大，载荷冲击波动等恶劣工况。

2BE1 series water ring vacuum pump is an efficient energy-saving product developed by our factory on the basis of scientific research and production experience, combined with the advanced technology of international similar products. Usually used for suction without solid particles, insoluble in water, corrosive gas, in order to form a vacuum and pressure in a closed container. By changing the results material, can also be used for suction of corrosive gas or a corrosive liquid. It is widely used in paper, chemical, petrochemical, light industry, pharmaceutical, food, metallurgy, building materials, stone tools, coal washing, mineral processing, fertilizer and so on. It has the advantages of simple structure, convenient maintenance, reliable operation, high efficiency and energy saving.

二、2BE1 系列真空泵主要技术参数 Main technical parameters of 2BE1 series vacuum pump

型号 Model	转速 (传动方式) speed (transmission mode) r/min	轴功率 shaft power KW	电机功率 Motor power KW	配用电机 Distribution motor 380V	极限真空度 Ultimate vacuum mbar	最大抽气速率 Maximum pumping rate		泵重 (整机) Benzhong (complete machine) kg
						M ³ /h	M ³ /min	
2BE1 202-0	970 (直连 Straight cascade)	17	22	Y200L2-6	33mbar (-0.098MPa)	760	12.7	875
	790 (皮带)	14	18.5	Y180M-4		590	9.8	850
	880 (皮带)	16	18.5	Y180M-4		670	11.2	850
	1100 (皮带)	22	30	Y200L-4		850	14.2	940
	1170 (皮带)	25	30	Y00L-4		890	14.8	945
	1300 (皮带)	30	37	Y225S-4		950	15.8	995
2BE1 203-0	970 (直连)	27	37	Y250M-6	33mbar (-0.098MPa)	1120	18.7	1065
	790 (皮带)	20	30	Y200L-4		880	14.7	995
	880 (皮带)	23	30	Y200L-4		1000	16.7	995
	1100 (皮带)	33	45	Y225M-4		1270	21.2	1080
	1170 (皮带)	37	45	Y225M-4		1320	22.0	1085
	1300 (皮带)	45	55	Y250M-4		1400	23.3	1170
2BE1 252-0	740 (直连)	38	45	Y280M-8	33mbar (-0.098MPa)	1700	28.3	1693
	558 (皮带)	26	30	Y200L-4		1200	20.0	1460
	660 (皮带)	31.8	37	Y225S-4		1500	25.0	1515
	832 (皮带)	49	55	Y250M-4		1850	30.8	1645
	885 (皮带)	54	75	Y280S-4		2000	33.3	1805
	938 (皮带)	60	75	Y280S-4		2100	35.0	1805
2BE1 253-0	740 (直连)	54	74	Y315M-8	33mbar (-0.098MPa)	2450	40.8	2215
	560 (皮带)	37	45	Y225M-4		1750	29.2	1695
	660 (皮带)	45	55	Y250M-4		2140	35.7	1785
	747 (皮带)	54	75	Y280S-4		2450	40.8	1945
	792 (皮带)	60	75	Y280S-4		2560	42.7	1945
	833 (皮带)	68	90	Y280M-4		2700	45.0	2055
	885 (皮带)	77	90	Y280M-4		2870	47.8	2060
	938 (皮带)	86	110	Y315S-4		3020	50.3	2295



昨天我们携手共经风雨
今天我们并肩共创辉煌
明天我们比翼共赢未来



注：本样本提供各系列产品外型尺寸、参数仅供选型参考，如有改动恕不另行通知。

Note: This sample provides the outline size of series products and the reference data is just for your selection of the type of products. If the data is changed, please pardon us that we can't instruct you in time.



山东沃仕玛真空设备科技有限公司

Shandong WoShiMa vacuum equipment technology co., LTD

电话：0536-3338798

传真：0536-3331818

手机：13325252380

E-mail: zhenguojixiea@163.com

地址：山东省潍坊市冶泉工业园